

## Parks & Playgrounds Capability



### Office Locations:

North Queensland Office  
457 Draper Street, Parramatta Park QLD 4870

Central Queensland Office  
8 The Crescent, Agnes Water QLD 4677  
Postal Address: PO Box 5397, Cairns QLD 4870  
T +61 7 4031 3993 E info@LA3.com.au

# about us



*“ we aim to create significant and viable spaces,  
with community and the entire life cycle in mind ”*

LA3 is a Queensland based local consultancy with landscape architecture, master planning and urban design professionals providing quality services for a diverse range of projects in Australia and Asia-Pacific. Now 12-years old, the LA3 business includes professionals with experience in the industry of more than 30-years. Our design approach is based on a detailed assessment of the natural systems of a given site and an understanding of the cultural heritage qualities of that place.

We provide creative, robust and strategic visions which result in innovative and practical site-responsive solutions. LA3 provides design services from concept through to detailed design and documentation, and supervision. We can lead the design process or support you in the documenting aspects of your design.

We can also prepare contemporary 2D and 3D visualisations. In providing these services, we aim to create significant and viable spaces, with the community and the entire life cycle in mind.

The LA3 Team advantage comes from its depth of experience in providing full suite of services including:

Landscape Architecture;  
Master Planning;  
Architecture;  
Urban Design;  
Planning;  
Consultation;  
Horticulture;  
Visual Impact Assessment;  
Design Management; and  
Graphics and Visualisations.

Our approach enables our clients to achieve quality design outcomes on time and on budget above expectations. We have experience in a wide range of environments locally and globally and we understand the socio-cultural and environment uniqueness of each. We understand that our clients want the best value for money and we partner with them to achieve mutually beneficial results.

We manage sub-consultants including:

- Civil & Structural Engineering
- Geotechnical & Arborists
- Environmental Consultants
- Specialist lighting Design
- Artists & Community Art Projects

We can manage your contract providing advice on:

- Tendering & Award
- Quality Inspections
- Practical Completion
- Final Completion Certificates



*Walla Steet Skate Park , Bundaberg, QLD - Designed by LA3*

# about us

*“ we aim to create significant and viable spaces,  
with community and the entire life cycle in mind ”*

## OUR PEOPLE

We are actively engaged in pushing the boundaries of design locally, putting our products at par with the rest of the world.

The LA3 team has undertaken projects of varying complexities both locally and overseas, and understands the importance of:

- Working collaboratively with clients to identify needs and develop project design and implementation strategies;
- Understanding the contextual and site opportunities and constraints, to develop a solid basis for future strategies;
- Formulating a vision for the future use and management of the facilities and open spaces.

## OUR PHILOSOPHY

A strong client-stakeholder-designer partnership inspires us. We strongly believe that a collaborative method of working brings out the best outcomes for all our projects. We always work with our clients and stakeholders to provide robust design solutions that benefit everyone in the partnership in all circumstances.

## OUR DIFFERENTIATORS

With numerous firms providing the same or similar set of services, LA3 must demonstrate its point of difference. Our commitment is to deliver premium service to our clients, strive to excel beyond our own limitations, improve upon our standards and continue setting high-standards. We take pride in sharing with you, a few of our differentiators:

- We are advocates of environmentally sustainable design and development;

- We value the inputs of others and we always practise a design approach collaboratively;
- We maintain a very reliable network and we partner with like-minded professionals depending on project requirements.
- We have a broad skill sets to manage a larger multidisciplinary team;
- With our global exposure, we have a great depth of combined individual experiences;
- We operate with a fresh philosophy.



*Sir Joseph Banks Park, Botany Bay, NSW - Designed by LA3*

# key people



## JOSEPH CORBIN

Managing Director, RLA AILA

Joseph is an AILA-Registered Landscape Architect with 30 years of professional experience in Northern Australia and Asia Pacific and 6 years in the Arabian Gulf. His long list of completed projects reflects his varied experience in design management, landscape architecture, urban design and landscape masterplanning.

He has a strong interest in the tropical Built Environment, place making, landscape and urban design. He enjoys co-design. He has managed large teams on landmark projects such as the Cardwell Foreshore Redevelopment. He was design manager of the significant Al Seef waterfront project for Aldar in Abu Dhabi in 2008 and the Doha Sports City in Qatar prior to that. He is currently designing Bargara Foreshore near Bundaberg.

He is based in Cairns as founding Director of LA3 and currently engaged in several important local projects including the Masterplanning of The Lake Eacham Visitor Facilities upgrade, Misson Beach Master plan and The Bellingen Main Street Redevelopment in NSW, and the Kuranda & Cardwell Cultural Precincts.

m: +61 410 773 772  
e: Joseph@LA3.com.au



## ANDREW PROWSE

Design Director, RLA AILA

Andrew has extensive landscape architectural experience in local community and tourism projects and has been responsible the design of many memorable landscapes in Port Douglas & Cairns. He was the Lead Landscape Architect for the Cairns Cultural Precinct (CPAC).

His design expertise has been recognised by many international, national and state awards including the Australia Council's inaugural Community Environment Art & Design Award for National Achievement in the Arts for the Gordonvale Townscape project. His projects have received several Australian Institute of Landscape Architect's Awards and his design for Munro Martin Parklands in Cairns new Entertainment Precinct won the AIA State Award for Urban Design & FNQ Project of the year Award. His work at the Reconciliation Rocks in Cooktown also won an AILA Award.

Andrew's strength is in connecting with the project team and stakeholders, the visioning of a project at the outset, and providing a unique and inspiring landscape character to a new developments.

m: +61 413 278 308  
e: Andrew@LA3.com.au



## JHAY BANIAGA

Senior Landscape Architect

Jhay is a Senior Landscape Architect with a wide range of professional experience locally and internationally working with LA3 for 7 years.

As well as leading the design documentation for the landmark Cardwell Foreshore project in Nth Qld, he has worked on all aspects of design for LA3 from sketch design to Detailed Design and documentation.

Jhay is familiar with Mossman and Port Douglas and the conditions of Far North Queensland, world tropics and has a keen interest in detailing of landscapes. He has skills in Master Planning and Public Consultation having worked as a facilitator. His solid experience in detailed documentation, conceptualisation and 3D visualisation demonstrates his skills as a talented designer.

t: +617 4031 3993  
e: Jhay@LA3.com.au

# project experience

## MUNRO MARTIN PARKLANDS Cairns, Queensland, Australia

Munro Martin Parklands is a 2.5 hectares of garden of significant cultural value. The 3000 seat amphitheatre & stage built in 2015-2016 for a budget of 11 million dollars has won several awards in Design Excellence.

The venue has been utilised extensively by international and famous bands and performances. When not operating as a venue, it is a parkland displaying tropical vines from throughout the globe. The merging of a historically significant local park with a new use has been incredibly successful.

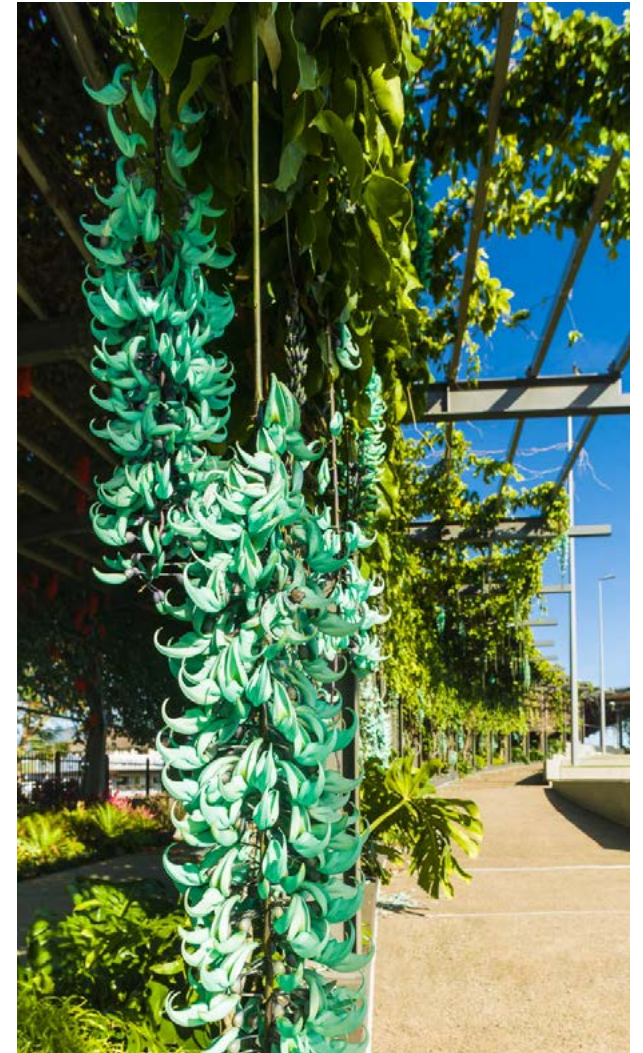
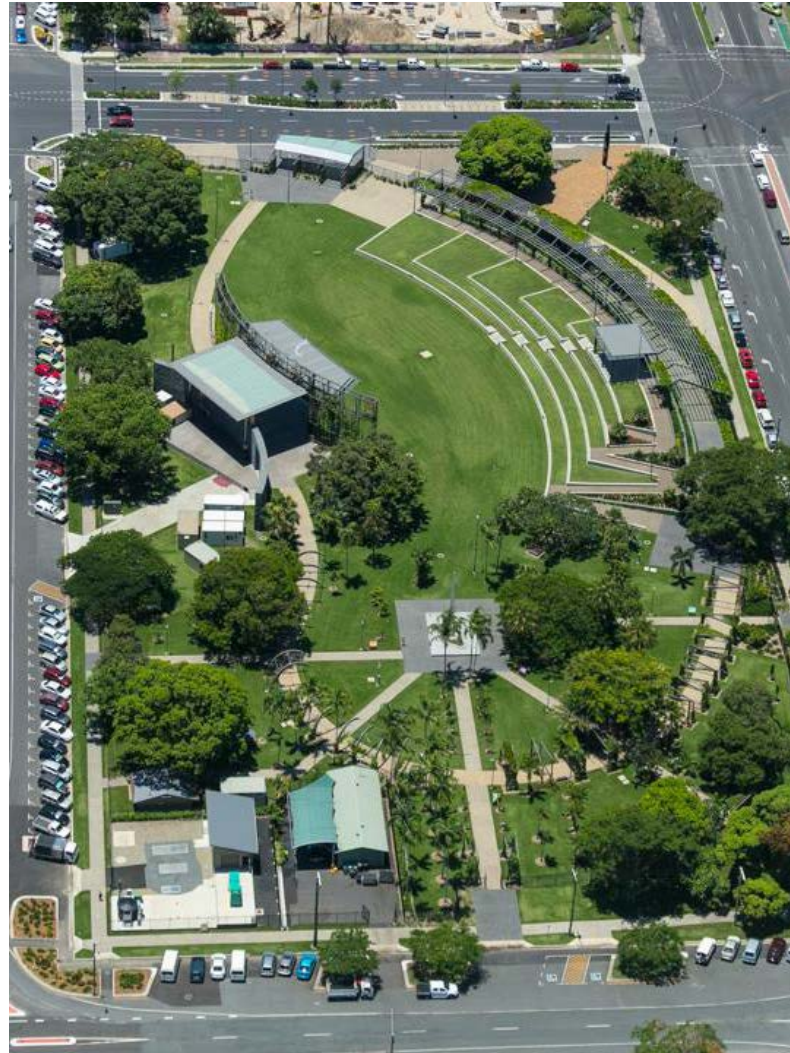

# project experience

MUNRO MARTIN PARKLANDS  
Cairns, Queensland, Australia



# project experience

## MOUNT ISA FAMILY FUN PARK Mount Isa, Queensland, Australia

Engaged by Mount Isa City Council as Senior Project Manager to deliver the entire life of project, including funding management, procurement, Master planning and detailed design and working with LA3, technical support and construction superintendent / PM.

The Park includes, 500m<sup>2</sup> skate park, 2500m<sup>2</sup> of insulated shade structures, 2000m<sup>2</sup> fun park, including splash pads, flying foxes, toddler-senior play areas, amphitheatres, fitness nodes and landscaped parklands for night markets.

Funding jointly by MICC The Department of Development, Manufacturing, Infrastructure & Planning

**Completion:** December 22

**Project Value:** \$ 7.9m



# project experience



MOUNT ISA FAMILY FUN PARK  
Mount Isa, Queensland, Australia





# project experience

## CENTRAL PARK SKATE PARK Bundaberg, Queensland, Australia

LA3 worked with CONVIC on the redevelopment plan for Central Park Skate Park in Bundaberg in 2020. The Walla Steet Skate Park opened on 25th June 2022. The team undertook public consultation in the form of a workshop with key stakeholders and park users and online consultation during the difficult COVID-19 restrictions. Project theming took inspiration from the local agricultural industry and its influence on the region's landscape character which was symbolically represented in the design through shapes, forms, materiality and layout. This approach has created a space that is site specific and provides the Bundaberg community with a truly unique skate park.

The new design provides: A beginner bowl, a street area, skate stairs and an advanced/ intermediate bowl. The design also provides landscape and shade and provision for universal access around the top of the bowl, a future amenities block, universal access shelter and seating, a drinking fountain, bike racks and feature tree planting in the form of the iconic Queensland Bottle Tree among other hardy plantings and retention of all existing trees. Some of the specifics of the Skate Bowl Works include: A double set stair with kink skate rails, taco corner with pool coping, central island and main bowl, escalator and extension, steep bank, pocket with pool coping, vert extension with platform QP, quarter pipe with tight pocket, pole jam, long flat ledge, flat bar round, china bank with kerb, doorway + stenciled concrete, euro manual pad, hubba ledge with upper kicker and a 4 set skate stair. Bundaberg Regional Council expect the new park to be a drawcard for the town while creating an overdue upgrade to the locally loved Walla Street Skate Park.

[See the video here.](#)



# project experience

## CENTRAL PARK SKATE PARK Bundaberg, Queensland, Australia



# project experience

## RECONCILIATION ROCKS COMMEMORATION PARK (2022 AILA QLD Award for Cultural Heritage) Cooktown, Queensland, Australia

This Federally funded memorial park commemorates the site and the first act of reconciliation after a conflict in 1770 between the Cook expedition and traditional landowners on the foreshore of what is present day Cooktown. The reconciliation took place at a large outcrop of boulders, still present today, although divided into 2 sections by a 19th Century gold rush railway cut. LA3 provided the Landscape Architectural component of design, documentation, and construction of the Reconciliation Rocks project for Cook Shire Council.

The design utilises the former rail cut to install, off the embankment, a series of shallow cast concrete and grass terraces to create an informal amphitheatre overlooking the significant remaining boulders where reenactment of the event occurs annually.

LA3 worked closely with the project Architects, CA Architects and local artist Braham Stevens, Cook Shire Council, and various stakeholders, including the Guugu Yimithirr Elders & Bama-ngay Traditional Custodians of the White & Black Cockatoo Clans, to help bring their nationally significant, ancestral reconciliation story to life in a symbolic empowering way. Along with the boulders the two artworks are the heroes of the project, one of the two clan cockatoo feathers, the other a portrait of the peace making elder.

The project, while delayed due to Covid 2020 Restrictions, was designed and delivered within budget for the rescheduled opening in June 2021.

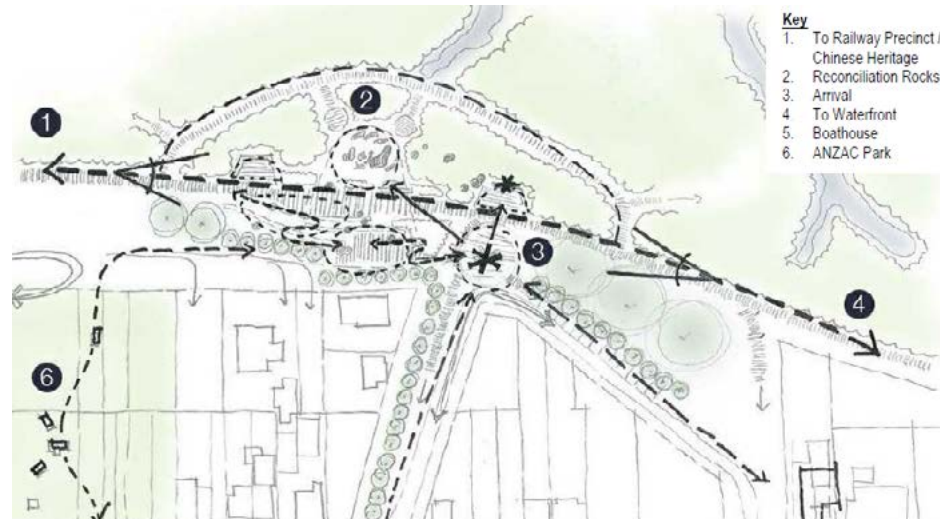

# project experience



RECONCILIATION ROCKS COMMEMORATION PARK (2022 AILA QLD Award for Cultural Heritage)  
Cooktown, Queensland, Australia



# project experience

VISTAS AT REDLYNCH  
Redlynch, Queensland, Australia



# project experience

## ALF LARSON PARK Miriam Vale, Queensland, Australia

The park has been designed to entice visitors off the highway to stop and enjoy the historical town of Miriam Vale. It features a giant luminous Skywalk system connected by four elevated bright green cabins.

The climb to the top via three angled nets and the high-speed way down via the two slides adds thrill to the overall experience. Along with other contemporary playground elements, the park caters to the various needs of growing kids in different age groups. These elements include a number of age appropriate equipment like coordination and balancing play equipment, sensory, physical, social and imaginative play alternatives, combined with a plethora of waterplay options.



# project experience



ALF LARSON PARK  
Miriam Vale, Queensland, Australia



# project experience

## CARDWELL FORESHORE RECONSTRUCTION Cardwell, Queensland, Australia

LA3 has been engaged as Landscape Architects for the landmark project to redesign the 3.5km foreshore and the townscape at Cardwell in North Queensland. The project is the outcome of an extensive public consultation and vision process held in Cardwell in 2011, post TC Yasi. Having carefully facilitated this process, our Principal Landscape Architect, Joseph Corbin developed concept options with the community then developed those community driven solutions into an agreed overall masterplan and community vision for this unique northern Australian coastal township.

The township and foreshore was devastated by the category 5 tropical cyclone Yasi in February 2011. Many people lost not only their belongings but their livelihoods and many had no option but to leave Cardwell. The town is located on the Bruce Hwy adjacent the World Heritage listed Hinchinrook Island and channel. It is the only stop on the coast when travelling from Cairns to Townsville. Many hope that the new works will revitalise this seaside town and help regain the former character whilst bringing a new heart and soul to the town. The community's ongoing involvement will ensure that the outcome is unique and will hold considerable local ownership.





# project experience



## CARDWELL FORESHORE RECONSTRUCTION Cardwell, Queensland, Australia



# project experience

CARDWELL FORESHORE RECONSTRUCTION  
Cardwell, Queensland, Australia

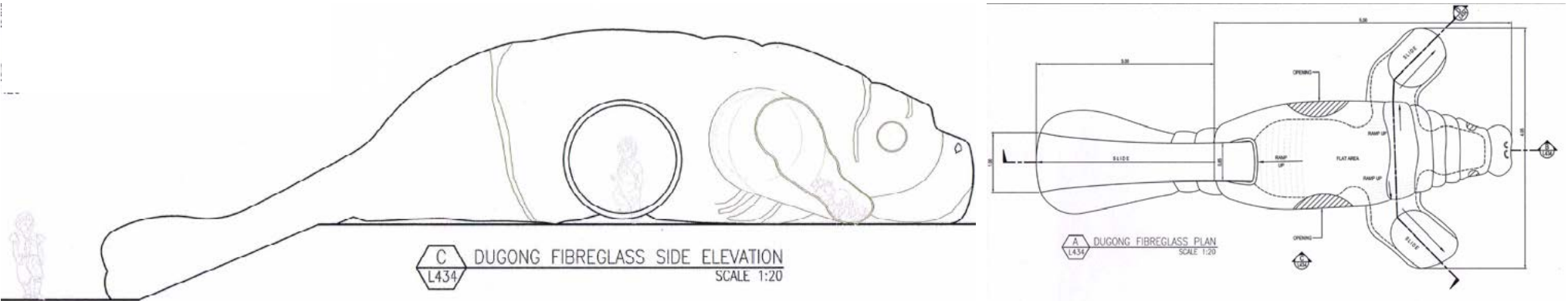

# project experience

## COOKTOWN WATERFRONT Cooktown, Queensland, Australia

Opened in November 2018, the Cooktown Foreshore project created a new public park on reclaimed land stretching from the existing wharves to the historic Gold Rush era explosives magazine building. New facilities includes a splash play, change rooms & amenities building with a cafe and lookout, fishing platforms, barbecues and picnic shelters and extensive lawns to hold public events.

Budget: \$20m

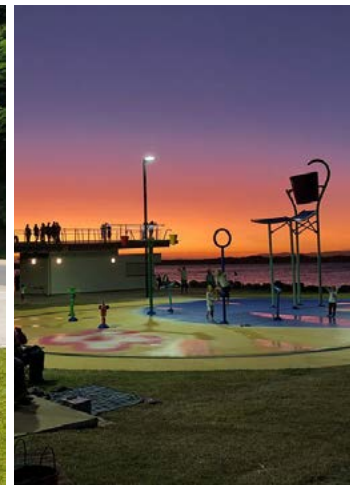

# project experience



## SMITHFIELD SHOPPING CENTRE CINEMA PLAYGROUND Smithfield, Queensland



# project experience



CAIRNS SPECIAL SCHOOL  
Cairns, Queensland, Australia





# project experience

## LARAPINTA CHILD AND FAMILY CARE Larapinta, Alice Springs, NT

LA3 has been engaged as the Landscape Architect for the new Larapinta's Child and Family Care facility in Alice Springs. The design involved several considerations in respect to the indigenous community and existing child care centre. The design solutions included local plantings, materials and forms around a nature play theme. A central meeting space serves as a gathering area for children, staff and parents while spaces are divide into different age groups to facilitate safe, passive and active play. The entire landscape and entry areas has artwork installations, and waterplay is a dominant feature. LA3 provided concept through to detailed design and visited Alice Springs on several occasions.



# project experience

## SIR JOSEPH BANKS PARK Botany Bay, New South Wales, Australia

The famous pleasure grounds by Botany Bay were the main attraction of the old Sir Joseph Banks Hotel in its heyday in the 19th Century. In the 1840's and 1850's, the Sir Joseph Banks Zoological and Botanical Gardens featured the colony's first zoo, arbours, walkways, sports areas including Australia's first professional foot racing tract, playgrounds, amphitheatre and a large lunch pavilion.

Over forty years since its decline in the 1920's, Botany Council decided to undertake an interpretative recreation of the former flamboyant Victorian Pleasure Gardens as its 1988 Bicentennial Project. As landscape architect for Botany Council, Andrew Prowse designed and supervised the \$1.2million rebuilding of these gardens in Victorian era style featuring a sports oval, thematic botanic gardens, a maze, pergolas and a lifesize bronze statue of Sir Joseph Banks. Australia's first zoo is also commemorated by a sculpture zoo animal playground.





# project experience

SIR JOSEPH BANKS PARK  
Botany Bay, New South Wales, Australia

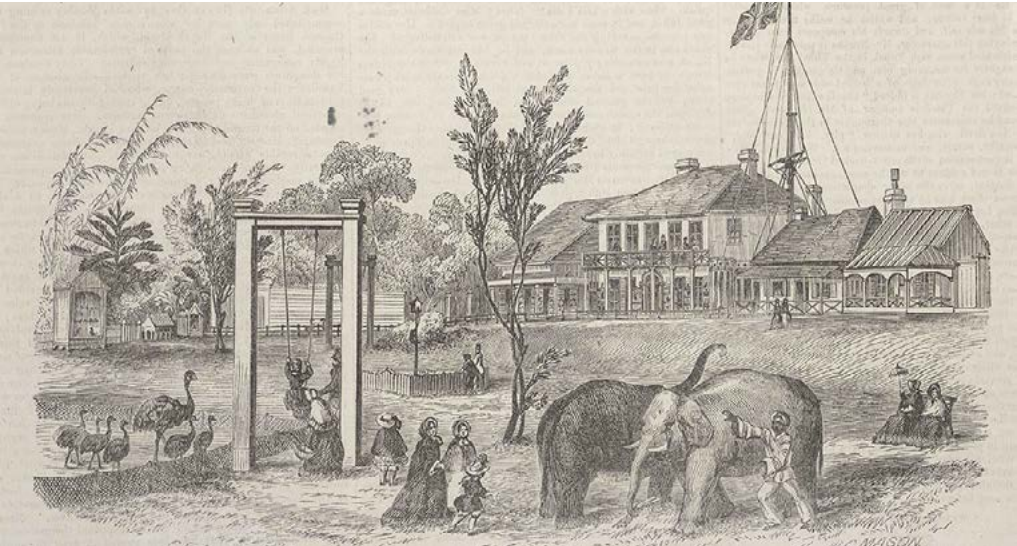

# project experience

## CAIRNS CHINESE FRIENDSHIP GARDEN Cairns, Queensland, Australia

This garden commemorates the Sister City Friendship between Cairns and Zhanjiang, China. In 2007 Zhanjiang opened the Sino-Australian Friendship Garden, a 40 hectare garden designed by Kim Morris & Andrew Prowse with Zhanjiang City Governments landscape team to celebrate the Sister City relationship. In 2015 Cairns Regional Council commissioned Kim & Andrew to design a Chinese garden that included a lakeside pavilion, Moon Gate, pergola and dramatic rock features.

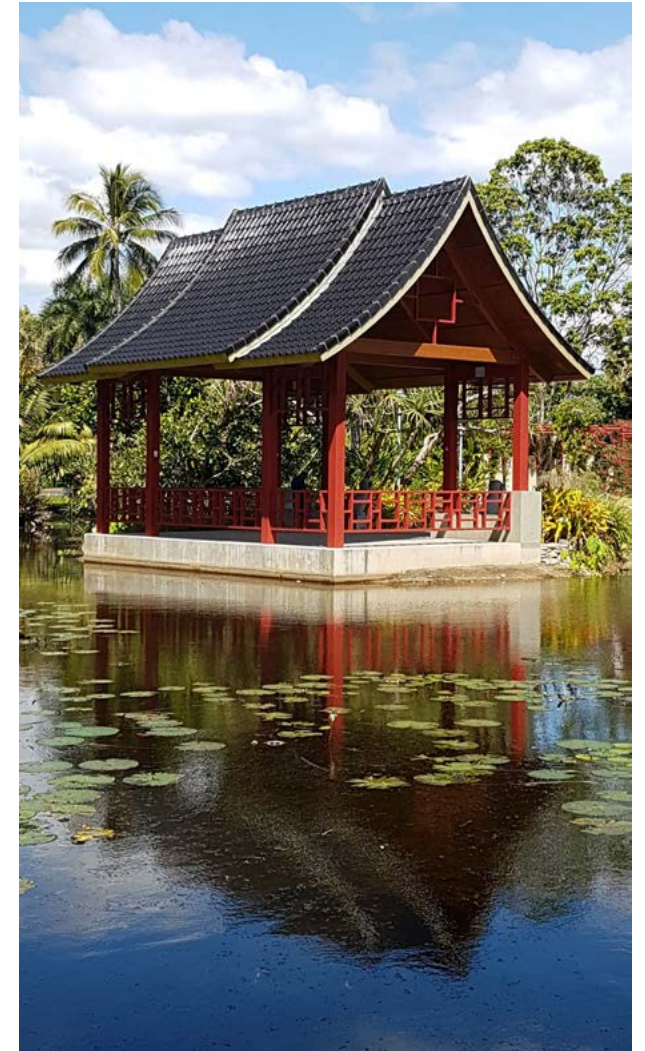

# project experience

## CAIRNS CHINESE FRIENDSHIP GARDEN Cairns, Queensland, Australia



# project experience

## CANE TOAD WORLD Gordonvale, Queensland

The history of the infamous release of the pest Cane Toad that occurred nearby Gordonvale in the 1920's is told in this children's playground with sculptures by Jean Paul & Gina Eeckhoudt & mosaics by Sam Fermo.



# project experience

CANE TOAD WORLD  
Gordonvale, Queensland



# project experience

## GORDONVALE TOWNSCAPE Gordonvale, Queensland

The Gordonvale Townscape & Tourism Strategy and Master Plan was initiated by the local community to address concerns held by residents on a future threatened by suburban growth. A townscape master plan was prepared to preserve the essential character of Gordonvale by interpreting the town's heritage. The result was based on extensive community consultation and participation through surveys, workshops and meetings allowing for the residents to direct the development of their own town.

Detail design and documentation included pavement mosaics, street and park furnishings and children's playground to interpret the town's history.

1993 The Australia Council considered this project is unique in Queensland in the scale of its public participation, collaboration and empowerment of the community and awarded the project the inaugural Community, Environment, Art & Design Award.

### AWARDS:

1993 The Australia Council's Awards for National Achievement in the Arts, the Inaugural CEAD Award.

1993 The Royal Australian Planning Institute Queensland Award for Excellence in Planning, Community Planning Award.



# project experience

GORDONVALE TOWNSCAPE  
Gordonvale, Queensland



# project experience



WARRINA LAKES COMMUNITY PARKLANDS  
Innisfail, Queensland, Australia





# project experience



WARRINA LAKES COMMUNITY PARKLANDS  
Innisfail, Queensland, Australia



# project experience

## NIELSON PARK UPGRADE Bargara, Queensland, Australia

LA3 is currently working on a masterplan for the upgrade of Nielson Park which is located on the beachfront at Bundaberg and is a major recreational asset for the Council being a focus point for Bargara and Bundaberg residents and visitors to the region. It is one of the Bundaberg Region's premier beachside recreation parks providing a variety of activities including a skate bowl, junior and senior play areas as well as providing access to the Nielson Park Bathing Reserve. The park is a popular destination park, frequented by both locals and visitors and is home to the Bargara Park Run and the Bargara Surf Life Saving Club. Currently, Council is undertaking a number of improvement works to activate the northern end of the recreation park through the installation of a formal carpark and shade structures over the adjacent skate bowl to further increase usage of the park.

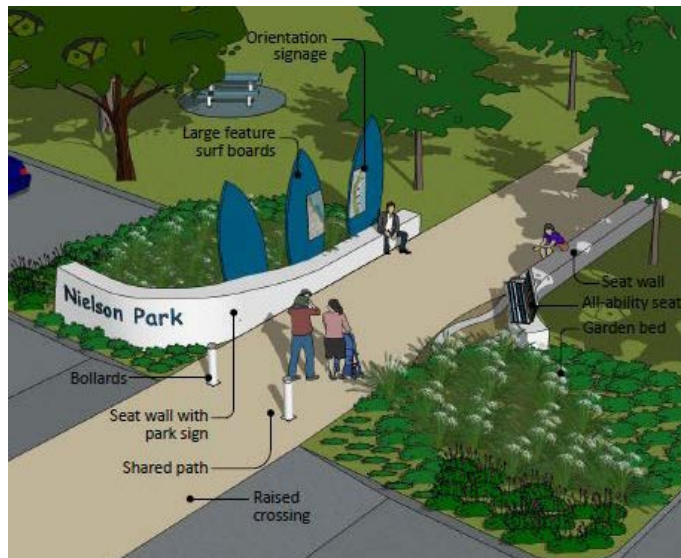

# project experience

## NIELSON PARK UPGRADE Bargara, Queensland, Australia

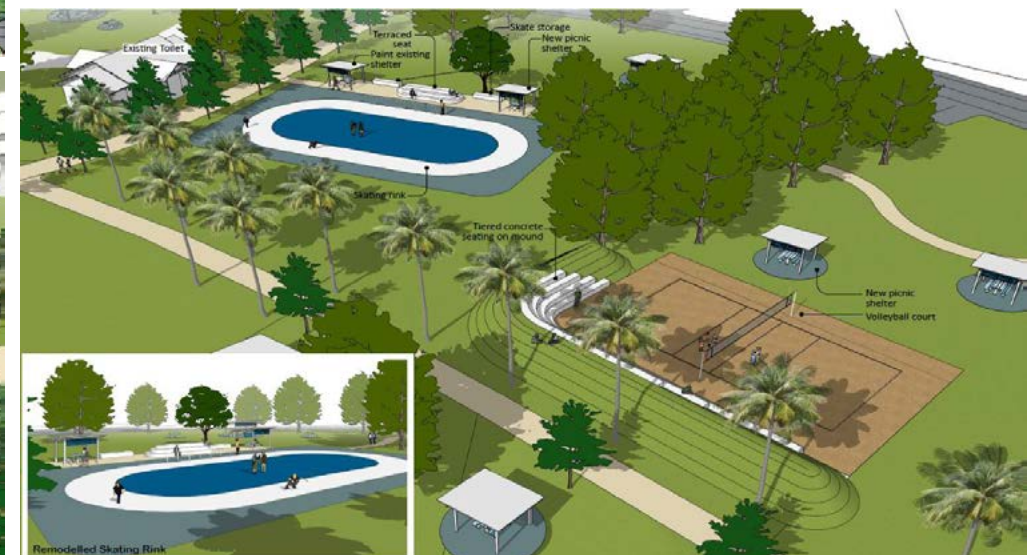
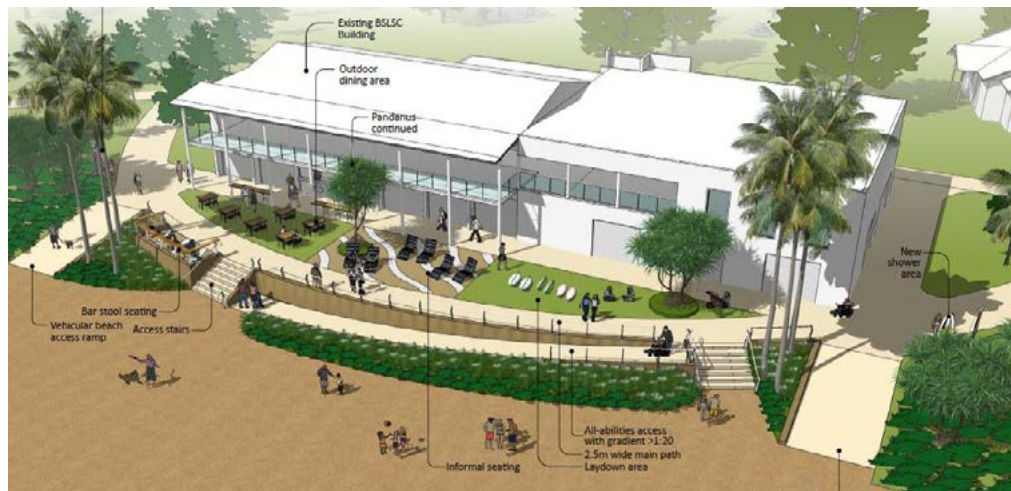

# project experience

## CARDWELL CULTURAL PRECINCT Cardwell, Queensland, Australia

On the back of the successful Cardwell Foreshore Reconstruction project, LA3 was invited back by the community to prepare concepts for the Cardwell Cultural Precinct. Adjacent the existing Edmund Kennedy Memorial Plaza, a new flexible multi-use open space design was created by LA3 and the community which includes a large open lawn area, plaza space, a mini stage, mini amphitheatre, playground and pedestrian linkages to the school, foreshore, railway station and library.

[See the video here.](#)



# project experience



CARDWELL CULTURAL PRECINCT  
Cardwell, Queensland, Australia



# project experience

## BOTANIC GARDEN MOSSMAN Mossman, Queensland, Australia

LA3 recently prepared the landmark Masterplan for the proposed Botanic Garden Mossman which will be the first of its kind built in the Wet Tropics World Heritage Area and showcase the world's oldest rainforest and the world's oldest living culture. This project is entirely community driven. The Wet Tropics of Far North Queensland contain the greatest concentration of primitive flowering plants anywhere in the world.

Visitors to the new Botanic Garden will witness how the Wet Tropic's special plants evolved in the last 40,000 years. Indigenous use and significance of these plants over the millennia is represented in specific focus gardens. Visitors can see plants that have changed the world and learn why, and are able to recognise the perilous state some species are in as a direct result. The journey illustrates the diversity and importance of plants to their existence.

The Botanic Garden Mossman will also offer long term economic development and new jobs to the region, by the creation of an iconic tourism destination.

LA3 worked with stakeholders and the Board of MBG Inc. to develop the Masterplan for the \$70M project.

[See the video here.](#)



# project experience



BOTANIC GARDEN MOSSMAN  
Mossman, Queensland, Australia

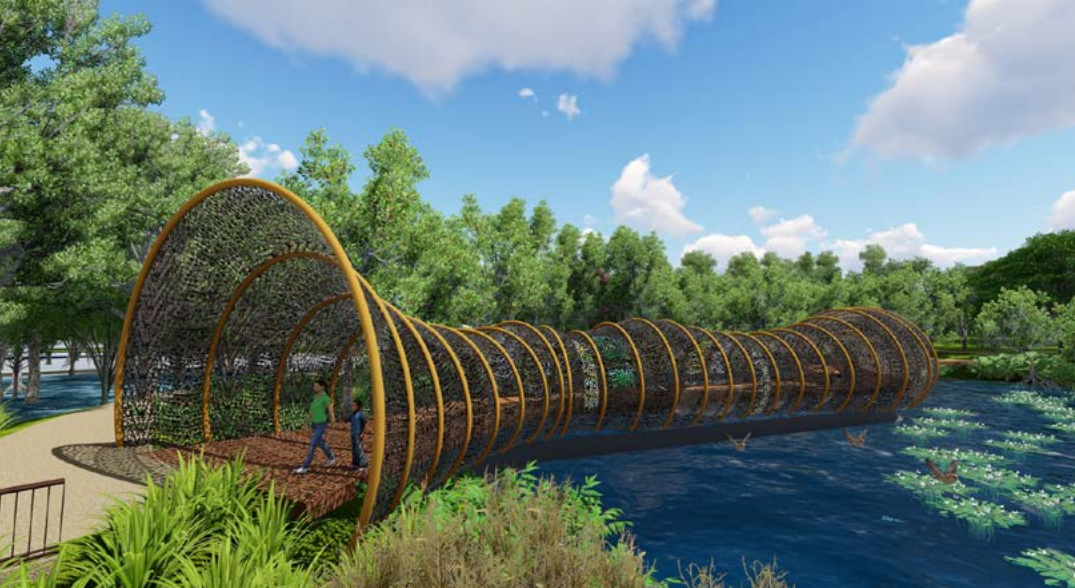

# project experience

## KURANDA COMMUNITY PRECINCT Kuranda Village, Queensland, Australia

LA3 worked with the Kuranda Community on the Masterplan for the Cultural Precinct which includes the conversion of the former State School to an amalgamation of current and future community facilities. The vision included catering for young and old users and future needs in the changing and challenging digital world besides the needs of the groups such as Artisans, Mens Shed, Library, Sports Community Garden and many other groups who wish to use the KCP in the future. The masterplan was well received and LA3 commended for their efforts in realising the communities joint vision.

[See the video here.](#)





# project experience



KURANDA COMMUNITY PRECINCT  
Kuranda Village, Queensland, Australia



# project experience

## MOSSMAN GORGE DISCOVERY PLAY Mossman, Queensland, Australia

Mossman Gorge in the Daintree National Park is a major attraction in Far North Queensland. Access to the gorge with its walking trails, suspension bridge and popular swimming holes is controlled through the indigenous run Mossman Gorge Visitor Centre and its shuttle bus service. Families and children groups are a large proportion of visitors and to enhance the family and education experience QNPWS are proposing to build an interpretative playground at the bus drop off & pick up point.

LA3 developed two concepts for a Discovery Play based on endemic flora. One scheme featured a Orb Spider web climbing structure and a Boyd's Forest Dragon at a larger than life scale while the second option has a discovery dig of the prehistoric Wallaby Proteomnodon skeleton and a Scrub Hen's nest at actual life size.

Bus and ranger parking is proposed to be rationalised along the provision of a new shelter structure and a small informal amphitheatre for guide talks. In association with this LA3 has documented new Class 2 surfaces for the walking trails that commence at this point including new riverside lookouts to assist manage more than a 1/3 million visitors yearly to the gorge.



# project experience



MOSSMAN GORGE DISCOVERY PLAY  
Mossman, Queensland, Australia



# project experience

## WALTON BRIDGE PARK The Gap, Queensland, Australia

LA3 has recently worked with The Gap Residents Association [www.4061.org.au](http://www.4061.org.au) to develop a Landscape Masterplan for Walton Bridge Park in The Gap, Brisbane. The spaces around Walton Bridge are currently disconnected and turn their back on the river.

Much work was done to revegetate the waterways of Enoggera & Fish Creek by local group S.O.W.N. [www.saveourwaterwaysnow.com.au](http://www.saveourwaterwaysnow.com.au) and now these attractive results need to be accessed and appreciated by the public in the form of lookouts, boardwalks, bridges and steps. The recovering waterways require linking back to the adjoining parklands.

Other aspects of the masterplan include a rejuvenated playspace with a new Skywalk by Urbanplay, riverside interaction areas, interpretation signage & education, a new amphitheatre and stage and a remodelled memorial plaza for ANZAC day commemorations. The upgrade of Walton Bridge is a community driven project and is aimed at creating a regional park facility compatible with contemporary family life and the needs of The Gap residents.

[See the video here.](#)



# project experience

WALTON BRIDGE PARK  
The Gap, Queensland, Australia



# project experience

## RAINFOREST EDGE SUBDIVISION Cairns, Queensland, Australia

Located on high ground above Mt. Sheridan on the south side of Cairns this estate has a rainforest backdrop with incredible views over Trinity Inlet. LA3 designed the entrance wall and boulevard, small parklands, playgrounds, creek side parkland and streetscape plantings for the project.

[See the video here.](#)



# project experience



PELICANS CHILDCARE CENTRE  
Cairns, Queensland, Australia



# project experience

JUST KIDS  
Gordonvale, Queensland, Australia







**Office Locations:**

**North Queensland Office**  
457 Draper Street, Parramatta Park QLD 4870

**Central Queensland Office**  
8 The Crescent, Agnes Water QLD 4677

**Postal Address:** PO Box 5397, Cairns QLD 4870  
T +61 7 4031 3993 E [info@LA3.com.au](mailto:info@LA3.com.au)