

Memorial Landscapes Capability



Office Locations:

North Queensland Office
457 Draper Street, Parramatta Park QLD 4870

Central Queensland Office
8 The Crescent, Agnes Water QLD 4677

Postal Address: PO Box 5397, Cairns QLD 4870
T +61 7 4031 3993 E info@LA3.com.au

about us

*“ we aim to create significant and viable spaces,
with community and the entire life cycle in mind ”*

LA3 is a Queensland based local consultancy with landscape architecture, master planning and urban design professionals providing quality services for a diverse range of projects in Australia and Asia-Pacific. Now 12-years old, the LA3 business includes professionals with experience in the industry of more than 30-years. Our design approach is based on a detailed assessment of the natural systems of a given site and an understanding of the cultural heritage qualities of that place.

We provide creative, robust and strategic visions which result in innovative and practical site-responsive solutions. LA3 provides design services from concept through to detailed design and documentation, and supervision. We can lead the design process or support you in the documenting aspects of your design.

We can also prepare contemporary 2D and 3D visualisations. In providing these services, we aim to create significant and viable spaces, with the community and the entire life cycle in mind.

The LA3 Team advantage comes from its depth of experience in providing full suite of services including:

Landscape Architecture;
Master Planning;
Architecture;
Urban Design;
Planning;
Consultation;
Horticulture;
Visual Impact Assessment;
Design Management; and
Graphics and Visualisations.

Our approach enables our clients to achieve quality design outcomes on time and on budget above expectations. We have experience in a wide range of environments locally and globally and we understand the socio-cultural and environment uniqueness of each. We understand that our clients want the best value for money and we partner with them to achieve mutually beneficial results.

We manage sub-consultants including:

- Civil & Structural Engineering
- Geotechnical & Arborists
- Environmental Consultants
- Specialist lighting Design
- Artists & Community Art Projects

We can manage your contract providing advice on:

- Tendering & Award
- Quality Inspections
- Practical Completion
- Final Completion Certificates



Proserpine Entertainment Centre, Proserpine, QLD - Designed by LA3

OUR PEOPLE

We are actively engaged in pushing the boundaries of design locally, putting our products at par with the rest of the world.

The LA3 team has undertaken projects of varying complexities both locally and overseas, and understands the importance of:

- Working collaboratively with clients to identify needs and develop project design and implementation strategies;
- Understanding the contextual and site opportunities and constraints, to develop a solid basis for future strategies;
- Formulating a vision for the future use and management of the facilities and open spaces.

OUR PHILOSOPHY

A strong client-stakeholder-designer partnership inspires us. We strongly believe that a collaborative method of working brings out the best outcomes for all our projects. We always work with our clients and stakeholders to provide robust design solutions that benefit everyone in the partnership in all circumstances.

OUR DIFFERENTIATORS

With numerous firms providing the same or similar set of services, LA3 must demonstrate its point of difference. Our commitment is to deliver premium service to our clients, strive to excel beyond our own limitations, improve upon our standards and continue setting high-standards. We take pride in sharing with you, a few of our differentiators:

- We are advocates of environmentally sustainable design and development;

- We value the inputs of others and we always practise a design approach collaboratively;
- We maintain a very reliable network and we partner with like-minded professionals depending on project requirements.
- We have a broad skill sets to manage a larger multidisciplinary team;
- With our global exposure, we have a great depth of combined individual experiences;
- We operate with a fresh philosophy.



Lutwyche Cemetery, Brisbane, QLD - Design by LA3

key people



JOSEPH CORBIN

Managing Director, RLA AILA

Joseph is an AILA-Registered Landscape Architect with 30 years of professional experience in Northern Australia and Asia Pacific and 6 years in the Arabian Gulf. His long list of completed projects reflects his varied experience in design management, landscape architecture, urban design and landscape masterplanning.

He has a strong interest in the tropical Built Environment, place making, landscape and urban design. He enjoys co-design. He has managed large teams on landmark projects such as the Cardwell Foreshore Redevelopment. He was design manager of the significant Al Seef waterfront project for Aldar in Abu Dhabi in 2008 and the Doha Sports City in Qatar prior to that. He is currently designing Bargara Foreshore near Bundaberg.

He is based in Cairns as founding Director of LA3 and currently engaged in several important local projects including the Masterplanning of The Lake Eacham Visitor Facilities upgrade, Misson Beach Master plan and The Bellingen Main Street Redevelopment in NSW, and the Kuranda & Cardwell Cultural Precincts.

m: +61 410 773 772
e: Joseph@LA3.com.au



ANDREW PROWSE

Design Director, RLA AILA

Andrew has extensive landscape architectural experience in local community and tourism projects and has been responsible the design of many memorable landscapes in Port Douglas & Cairns. He was the Lead Landscape Architect for the Cairns Cultural Precinct (CPAC).

His design expertise has been recognised by many international, national and state awards including the Australia Council's inaugural Community Environment Art & Design Award for National Achievement in the Arts for the Gordonvale Townscape project. His projects have received several Australian Institute of Landscape Architect's Awards and his design for Munro Martin Parklands in Cairns new Entertainment Precinct won the AIA State Award for Urban Design & FNQ Project of the year Award. His work at the Reconciliation Rocks in Cooktown also won an AILA Award.

Andrew's strength is in connecting with the project team and stakeholders, the visioning of a project at the outset, and providing a unique and inspiring landscape character to a new developments.

m: +61 413 278 308
e: Andrew@LA3.com.au



JHAY BANIAGA

Senior Landscape Architect

Jhay is a Senior Landscape Architect with a wide range of professional experience locally and internationally working with LA3 for 7 years.

As well as leading the design documentation for the landmark Cardwell Foreshore project in Nth Qld, he has worked on all aspects of design for LA3 from sketch design to Detailed Design and documentation.

Jhay is familiar with Mossman and Port Douglas and the conditions of Far North Queensland, world tropics and has a keen interest in detailing of landscapes. He has skills in Master Planning and Public Consultation having worked as a facilitator. His solid experience in detailed documentation, conceptualisation and 3D visualisation demonstrates his skills as a talented designer.

t: +617 4031 3993
e: Jhay@LA3.com.au

project experience

PROSERPINE ENTERTAINMENT CENTRE
Proserpine, Queensland, Australia

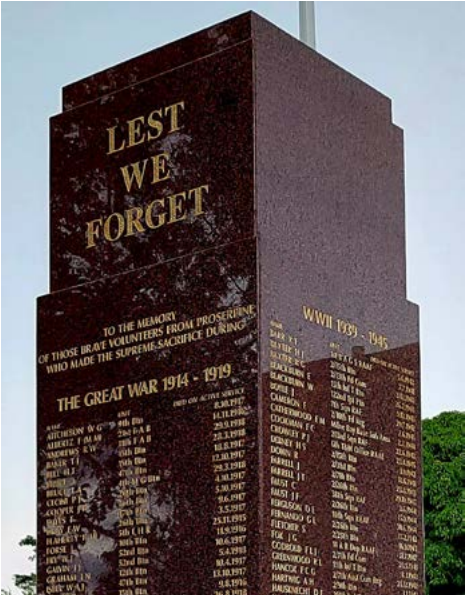

project experience

RECONCILIATION ROCKS COMMEMORATION PARK (2022 AILA QLD Award for Cultural Heritage) Cooktown, Queensland, Australia

This Federally funded memorial park commemorates the site and the first act of reconciliation after a conflict in 1770 between the Cook expedition and traditional landowners on the foreshore of what is present day Cooktown. The reconciliation took place at a large outcrop of boulders, still present today, although divided into 2 sections by a 19th Century gold rush railway cut. LA3 provided the Landscape Architectural component of design, documentation, and construction of the Reconciliation Rocks project for Cook Shire Council.

The design utilises the former rail cut to install, off the embankment, a series of shallow cast concrete and grass terraces to create an informal amphitheatre overlooking the significant remaining boulders where reenactment of the event occurs annually.

LA3 worked closely with the project Architects, CA Architects and local artist Braham Stevens, Cook Shire Council, and various stakeholders, including the Guugu Yimithirr Elders & Bama-ngay Traditional Custodians of the White & Black Cockatoo Clans, to help bring their nationally significant, ancestral reconciliation story to life in a symbolic empowering way. Along with the boulders the two artworks are the heroes of the project, one of the two clan cockatoo feathers, the other a portrait of the peace making elder.

The project, while delayed due to Covid 2020 Restrictions, was designed and delivered within budget for the rescheduled opening in June 2021.

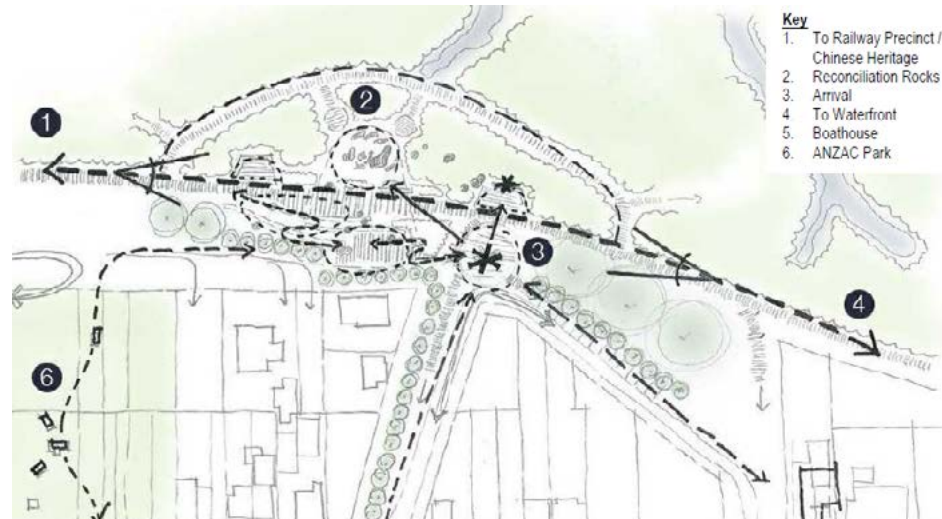

project experience

RECONCILIATION ROCKS COMMEMORATION PARK (2022 AILA QLD Award for Cultural Heritage)
Cooktown, Queensland, Australia



project experience

ROCKY CREEK WAR MEMORIAL PARK Tolga, Queensland, Australia

LA3 was commissioned by Tablelands Regional Council to create a new war memorial for the Rocky Creek Memorial Park between Tolga and Walkamin. Rocky Creek was the location of the largest WWII military hospital in the southern hemisphere, a 3,000 bed hospital that treated over 60,000 wounded between 1943 to 1945. The park features plaques and colours of the various units associated with the hospital set on local granite boulders, the first being unveiled in 1995 the 50th Anniversary of Victory in the Pacific (VP Day).

To celebrate the 75th Anniversary of VP Day, our new entrance walls and memorial with a sculpture by local artist Amanda Feher was unveiled at a moving ceremony. Amanda's sculpture of a doctor and nurse with a soldier patient is based on a WWII photograph.



project experience



ROCKY CREEK WAR MEMORIAL PARK
Tolga, Queensland, Australia



project experience

LUTWYCHE CEMETERY Brisbane, Queensland, Australia

The refurbishment of Lutwyche War Cemetery included removal, restoration and re-installing of headstones along with a new planting scheme to Commonwealth War Graves Commission standards.



project experience



LUTWYCHE CEMETERY
Brisbane, Queensland, Australia



project experience

ATHERTON WAR CEMETERY Atherton, Queensland, Australia

Management plan for the cemetery turf including soil testing, refurbishment strategy and management guidance.



project experience

LAE WAR CEMETERY Lae, Papua New Guinea

Cemetery landscape management plans to guide ongoing works to the three Commonwealth Cemeteries in Papua New Guinea- Bomana (3,824 graves), Lae (2,818 graves) and Bita Paka near Rabual (1,114 graves).

Current conditions plans were prepared based on original plans, more recent survey and works plans and site measurements. Management tasks included restoring cemetery plantings to Commonwealth War Graves Commission standards. Plant data sheets of over 100 plants suitable for use in the cemeteries were prepared including information of where to be used in the planting hierarchy, care and propagation.



project experience



LAE WAR CEMETERY
Lae, Papua New Guinea



project experience

BOMANA WAR CEMETERY Port Moresby, Papua New Guinea

Planting plans prepared for a new planting scheme to Commonwealth War Graves Commission standards.



project experience



BOMANA WAR CEMETERY
Port Moresby, Papua New Guinea



project experience

BITA PAKA WAR MEMORIAL Rabaul, Papua New Guinea

Design and documentation of a new battle memorial outside of Bita Paka War Cemetery, Rabaul to commemorate Australia's first battle action in World War 1 (11th September 1914) and to memorialise the loss at sea of the AE1 Submarine in Rabaul Harbour on 14th September 1914. The design of the memorial included interpretation of German- wireless tower the object of the Australian attack as an inlay into the pavement. The design of the memorial gives an new direction to visitors to the war cemetery to align with a more direction approach to the cemetery entrance and geometry.



project experience

BITA PAKA WAR MEMORIAL Rabaul, Papua New Guinea



project experience

TULLY LAWN CEMETERY Nauru, Queensland, Australia

Design and documentation of an stand alone extension to Tully Cemetery for lawn burials. Design included master planning for the existing cemetery, memorial locations and future memorial entrance features.



project experience

CARDWELL FORESHORE RECONSTRUCTION Cardwell, Queensland, Australia

LA3 has been engaged as Landscape Architects for the landmark project to redesign the 3.5km foreshore and the townscape at Cardwell in North Queensland. The project is the outcome of an extensive public consultation and vision process held in Cardwell in 2011, post TC Yasi. Having carefully facilitated this process, our Principal Landscape Architect, Joseph Corbin developed concept options with the community then developed those community driven solutions into an agreed overall masterplan and community vision for this unique northern Australian coastal township.

The township and foreshore was devastated by the category 5 tropical cyclone Yasi in February 2011. Many people lost not only their belongings but their livelihoods and many had no option but to leave Cardwell. The town is located on the Bruce Hwy adjacent the World Heritage listed Hinchinrook Island and channel. It is the only stop on the coast when travelling from Cairns to Townsville. Many hope that the new works will revitalise this seaside town and help regain the former character whilst bringing a new heart and soul to the town. The community's ongoing involvement will ensure that the outcome is unique and will hold considerable local ownership.

Budget: \$8m



project experience

CARDWELL FORESHORE RECONSTRUCTION Cardwell, Queensland, Australia

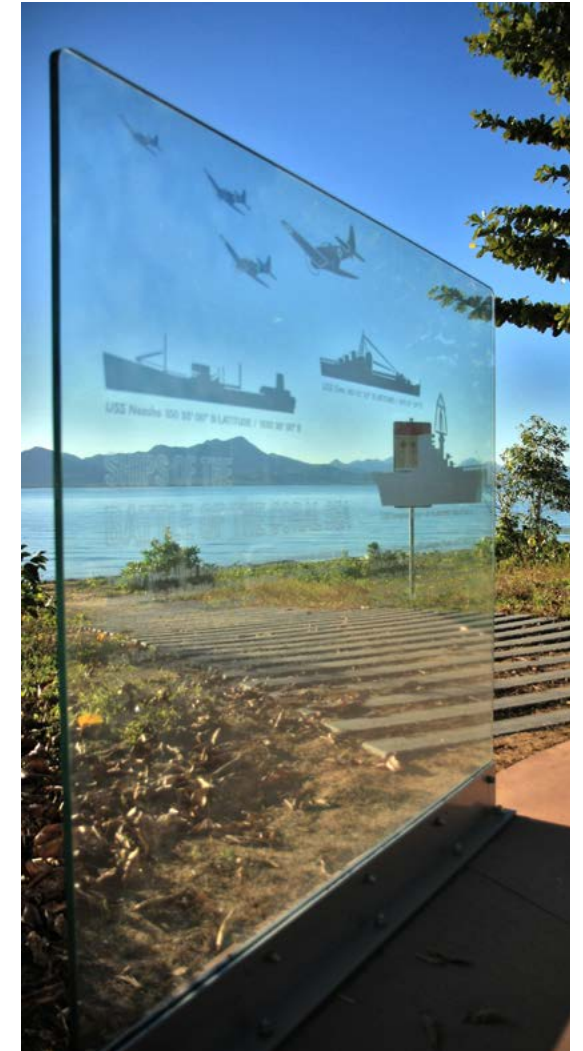

project experience



CARDWELL FORESHORE RECONSTRUCTION Cardwell, Queensland, Australia



project experience

BELLINGEN STREETScape Bellingen, NSW, Australia

Bellingen's main street, Hyde Street, is an important spine for the central business activity of Bellingen. It provides an important link to the major establishments and business developments in town. The new design by LA3 enhances this link by significantly increasing pedestrian comfort and addresses safety issues by providing a more pleasant streetscape environment.

Our proposed design transforms Bellingen Main Street into a public pedestrian space whilst maintaining traffic flows that emphasise connectivity between the surrounding shops, links to community facilities and the creation of social areas. The design process involved preparation of a site analysis report, conceptual design, liaison with community groups and then the development of design options based on feedback from such community consultations.

The construction of this new streetscape is currently underway.

[See the video here.](#)



project experience

BELLINGEN STREETScape Bellingen, NSW, Australia



project experience

BELLINGEN STREETScape Bellingen, NSW, Australia



project experience

CITIZENS OF THE GREAT BARRIER REEF Cairns, Queensland, Australia

This is a landscape proposal to provide a landscape setting for a significant public art piece by Cairns artist Brian Robinson located on the Cairns Esplanade foreshore. The design referencing Sea Grasses reinforces the marine theme of the sculpture while providing scenic vantage points for viewers.



project experience

CITIZENS OF THE GREAT BARRIER REEF Cairns, Queensland, Australia

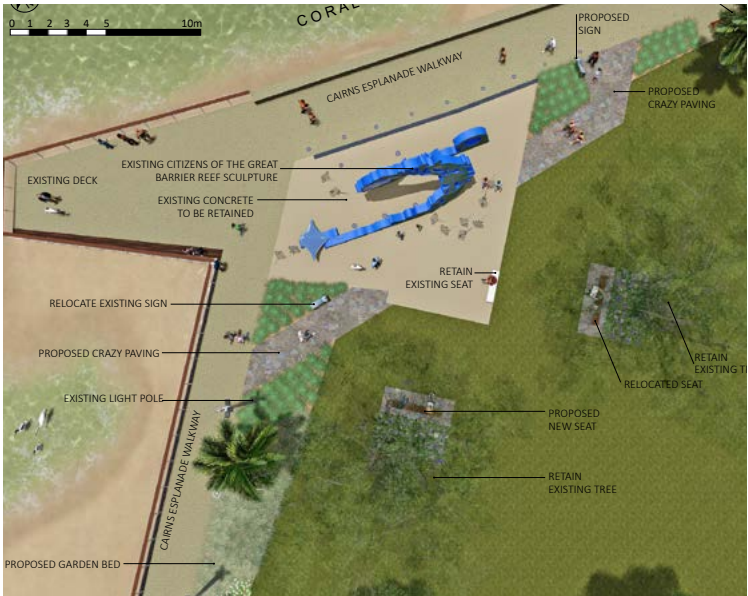

project experience

GORDONVALE TOWNSCAPE Gordonvale, Queensland

The Gordonvale Townscape & Tourism Strategy and Master Plan was initiated by the local community to address concerns held by residents on a future threatened by suburban growth. A townscape master plan was prepared that preserved the essential character of Gordonvale by interpreting the town's heritage. The result was based on extensive community consultation and participation through surveys, workshops and meetings allowing for the residents to direct the development of their own town.

Detail design and documentation included pavement mosaics, street and park furnishings and children's playground to interpret the town's history.

1993 The Australia Council considered this project is unique in Queensland in the scale of its public participation, collaboration and empowerment of the community and awarded the project the inaugural Community, Environment, Art & Design Award.

AWARDS:

1993 The Australia Council's Awards for National Achievement in the Arts, the Inaugural CEAD Award.
1993 The Royal Australian Planning Institute Queensland Award for Excellence in Planning, Community Planning Award.



project experience

GORDONVALE TOWNSCAPE
Gordonvale, Queensland



project experience

CAPE WOM INTERNATIONAL MEMORIAL Wewak, Papua New Guinea

Refurbishment plan for the Cape Wom Memorial Park commemorating the Japanese unconditional surrender in WWII on a wartime airstrip on 13th September 1945. Tasks included preparation of an existing conditions plan and planting plans.



project experience



JOHN FRENCH VC MEMORIAL Alotau, Papua New Guinea

Design of a new memorial to Victoria Cross recipient John 'Jack' French for gallant action during the WWII Battle for Milne Bay including interpretation plaques and a sculptural representation of the Victoria Cross.



project experience

NAURU CHUUK LAGOON SURVIVORS MEMORIAL Nauru, Queensland, Australia

Concepts for a new memorial to the Chuuk Lagoon survivors from the time of the WWII Japanese occupation to be built on the Nauru waterfront as part of the redevelopment of the Nauru port facilities. The interpretation design strategy included a sculptural representation of a Nauruan family group and the return ship Trienza.

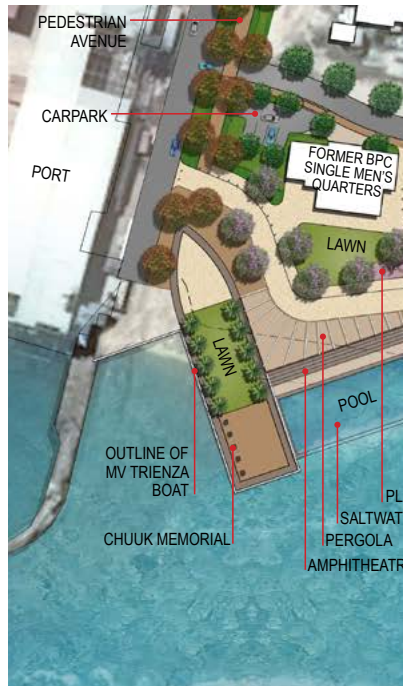

project experience

NATIONAL WORLD WAR MEMORIAL Canberra, Australia

Submitted entry in the design competition for the National World Wars Memorial in Canberra on the shore of Lake Burley Griffin.

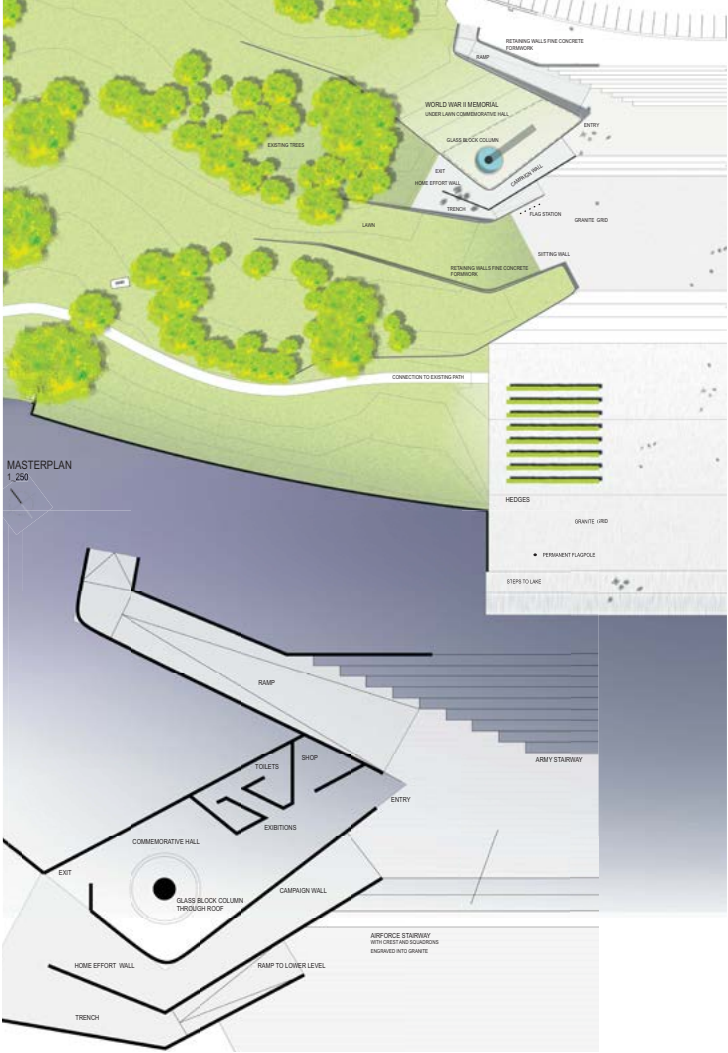
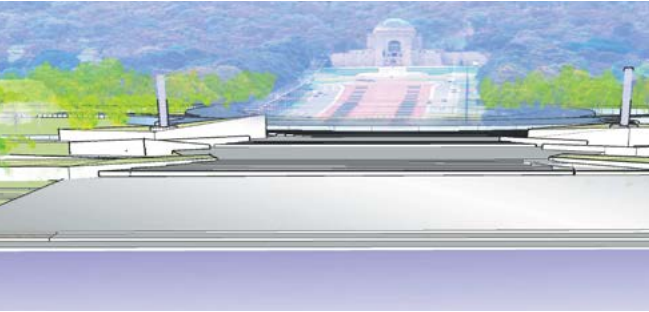
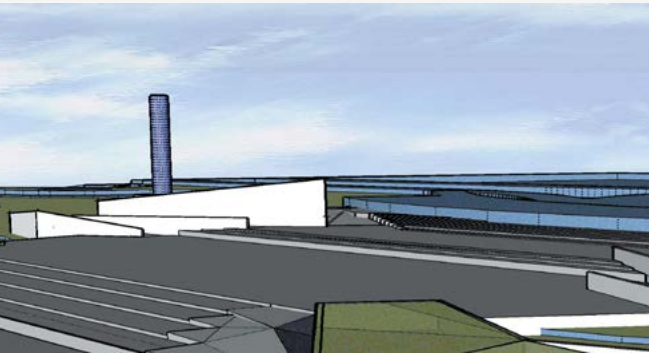
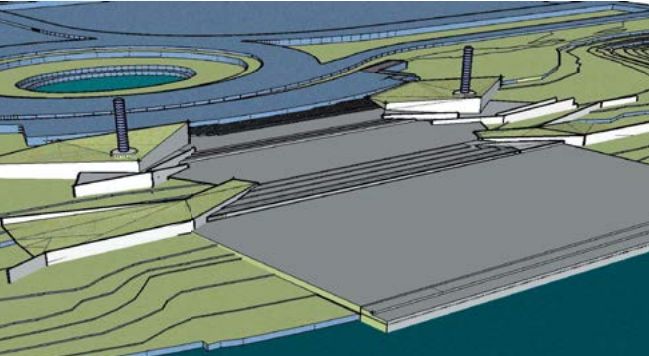
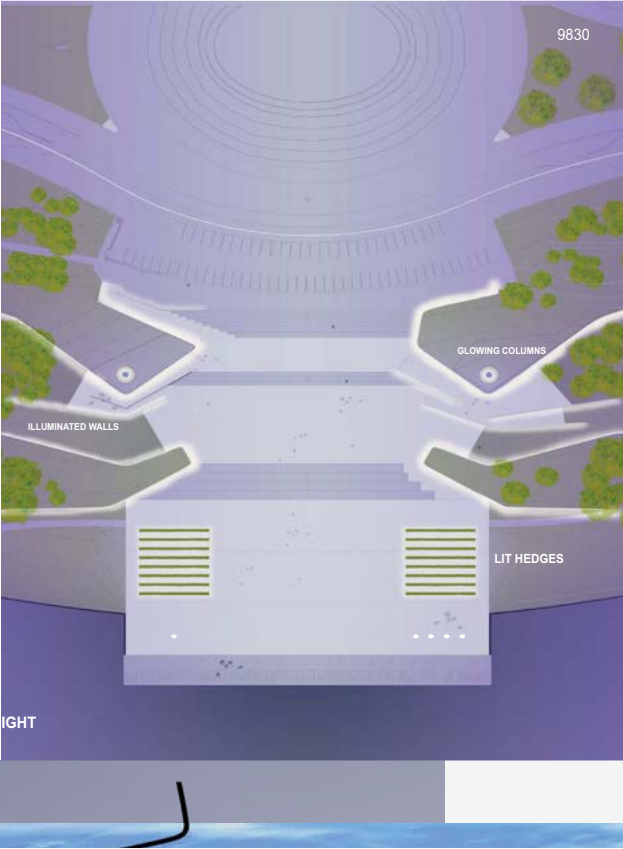

project experience

ROCKHAMPTON WAR CEMETERY Rockhampton, Queensland, Australia

Refurbishment of Rockhampton War Cemetery including new plantings to Commonwealth War Graves Commission standards. A new gateway to the cemetery was designed and constructed to facilitate all abilities access.

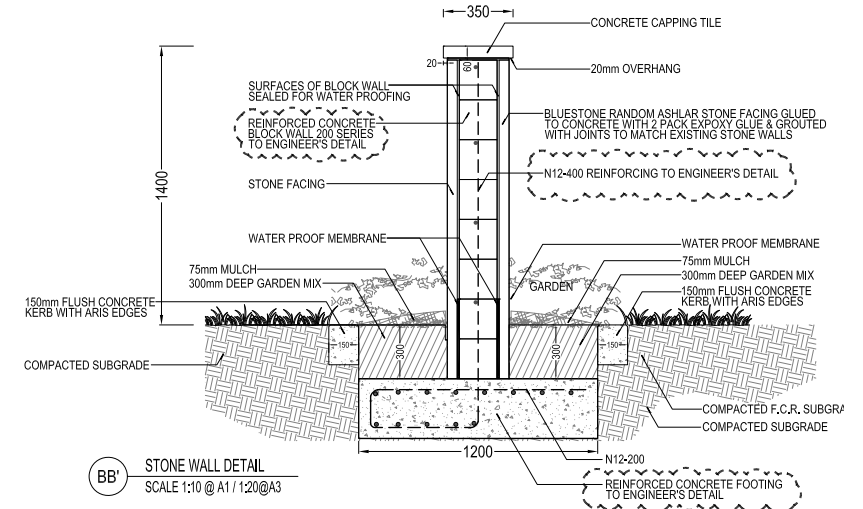
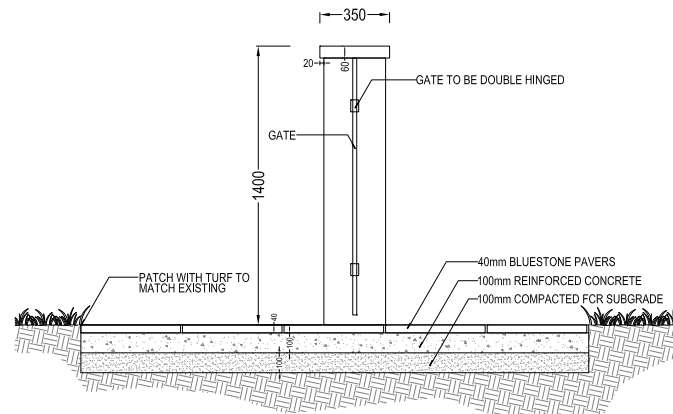
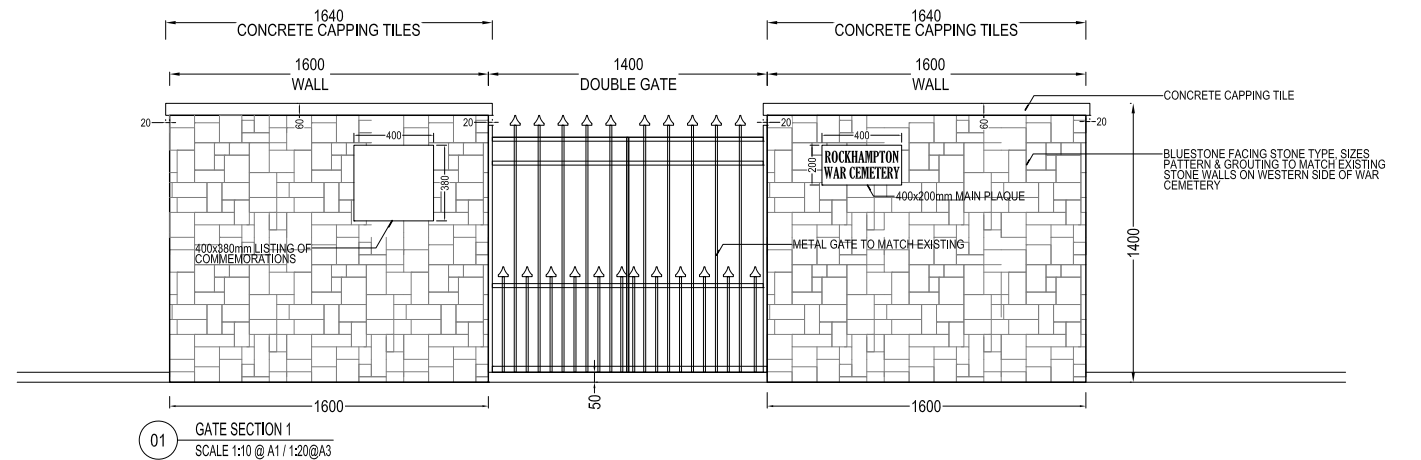



Office Locations:

North Queensland Office
457 Draper Street, Parramatta Park QLD 4870

Central Queensland Office
8 The Crescent, Agnes Water QLD 4677

Postal Address: PO Box 5397, Cairns QLD 4870
T +61 7 4031 3993 E info@LA3.com.au